



3101 Hillsborough Street • Raleigh, NC

# THE STANDARD AT RALEIGH

NC STATE  
UNIVERSITY

±6,163 SF RETAIL OPPORTUNITIES





3101 Hillsborough Street • Raleigh, NC

# THE STANDARD AT RALEIGH

±6,163 SF Retail Opportunities

For more info, please contact:

**MATTHEW STEIN**

mstein@MSCretail.com  
215.883.7407

**MARIA MAINARDI**

mmainardi@MSCretail.com  
215.883.7393



## PROPERTY DETAILS

- ▶ New construction mixed-use student housing project on the doorstep of North Carolina State University
- ▶ Comprised of 707 beds (233 units) and ±6,163 SF of ground floor retail and restaurant opportunities
- ▶ A rock's throw from campus and the athletic fields; tremendous visibility and foot traffic with access to public transportation
- ▶ Set in the heart of the city and along the retail corridor, this location provides easy access to adjacent retail and restaurants
- ▶ Minutes away from the State Capitol building, the Convention Center and surrounding parks
- ▶ Delivery to retailers June 2020

## DEMOGRAPHICS

"Trade Area" (Greater Midtown Boundary)

"Core" (Midtown Improvement District)

### 2018 EST. POPULATION

1 mile: 20,564   3 mile: 100,822   5 mile: 218,083

### 2018 AVERAGE HH INCOME

1 mile: \$65,991   3 mile: \$90,543   5 mile: \$86,690

### 2018 EST. TOTAL EMPLOYEES

1 mile: 10,191   3 mile: 103,284   5 mile: 187,869

### EST. WHITE COLLAR WORKERS

1 mile: 71.8%   3 mile: 74.0%   5 mile: 72.4%

### NC STATE UNIVERSITY

Undergraduate Students	±24,500
Graduate	±11,000
Total Student Population	±35,500
Faculty/Staff	±8,800

©2018 SitesUSA, Inc.



3101 Hillsborough Street • Raleigh, NC

# THE STANDARD AT RALEIGH

Site Plan

For more info, please contact:

**MATTHEW STEIN**

mstein@MSCretail.com  
215.883.7407

**MARIA MAINARDI**

mmainardi@MSCretail.com  
215.883.7393

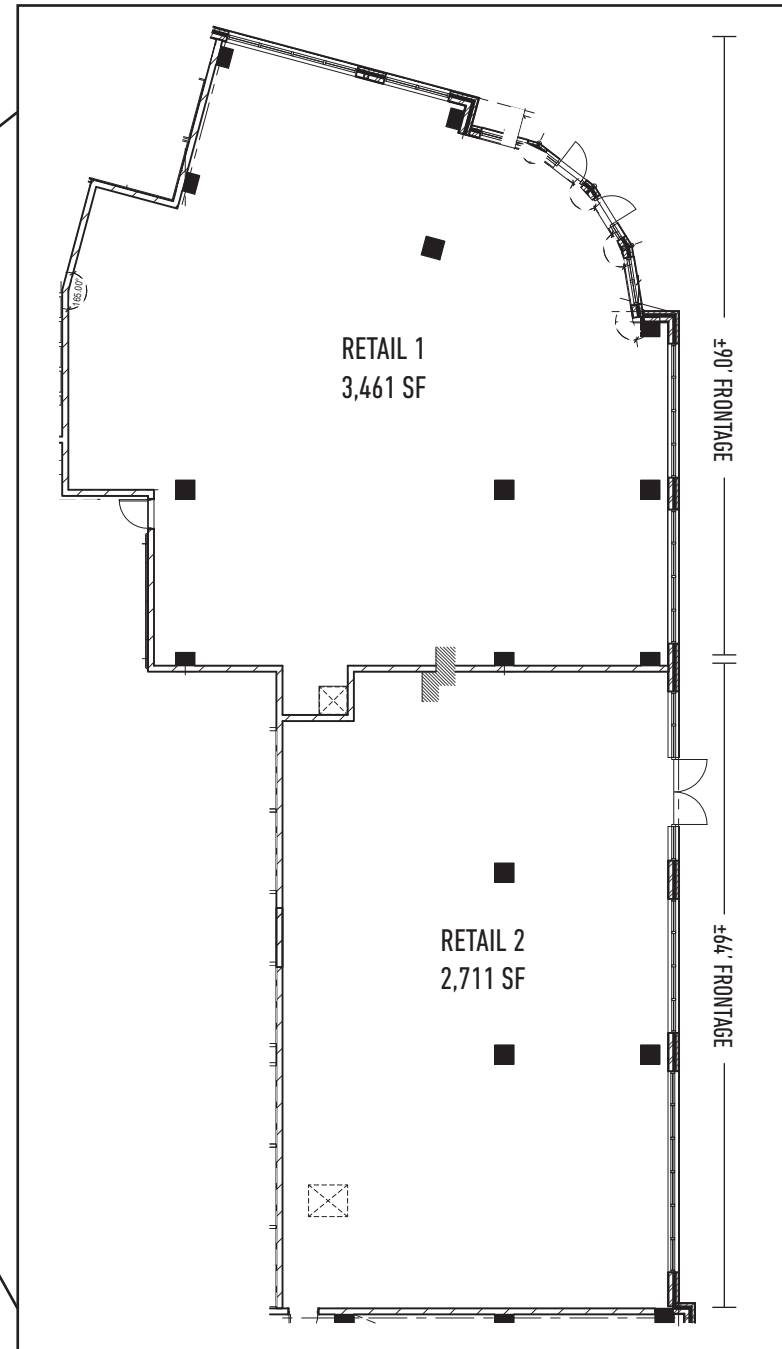
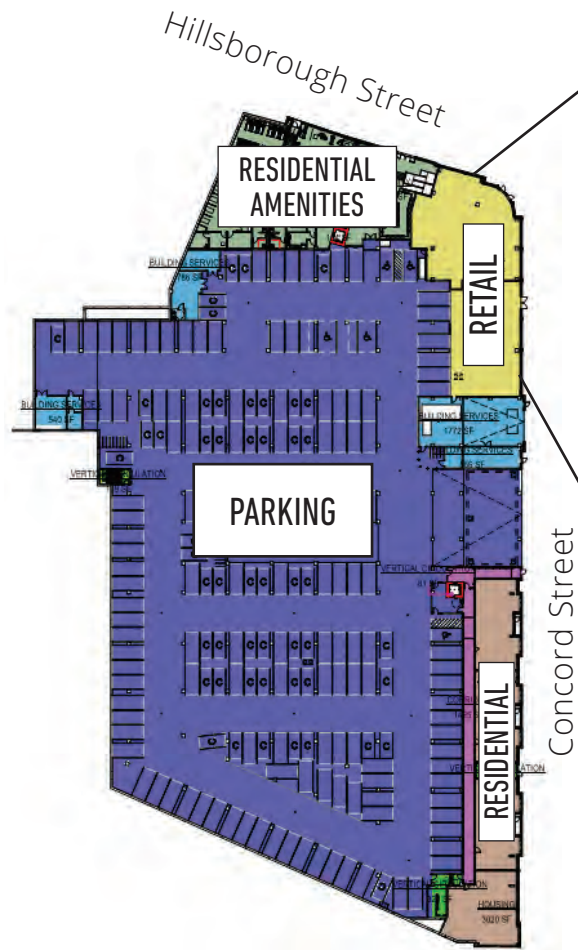



3101 Hillsborough Street • Raleigh, NC

# THE STANDARD AT RALEIGH

Aerial

For more info, please contact:

**MATTHEW STEIN**

mstein@MSCretail.com  
215.883.7407

**MARIA MAINARDI**

mmainardi@MSCretail.com  
215.883.7393

